



In-Station Training

TM 24-35 Mobile Home Fire



Author

Chief Ed Hartin

Purpose

Mobile and manufactured homes are constructed on a metal frame with axles to allow transportation to the home site. Wood framing is much lighter than typical stick built (or modular) homes. Understanding mobile and manufactured home construction and design is essential to safe and effective firefighting operations in this type of building.

Learning Outcomes

Firefighters and officers perform an effective size-up, select an appropriate strategy, and implement tactics based on the strategic decision-making model.

Conducting the Drill

This incident involved a residential fire at 1565 Sherin Drive NE in Grand Rapids, Michigan on August 1, 2024 at 13:30 (GWW09, 2024 & Fox 17 News, 2024). Review the map and photos (Figures 1-4) to gain an understanding of the area and building involved.

Figure 1. Map of the Incident Area

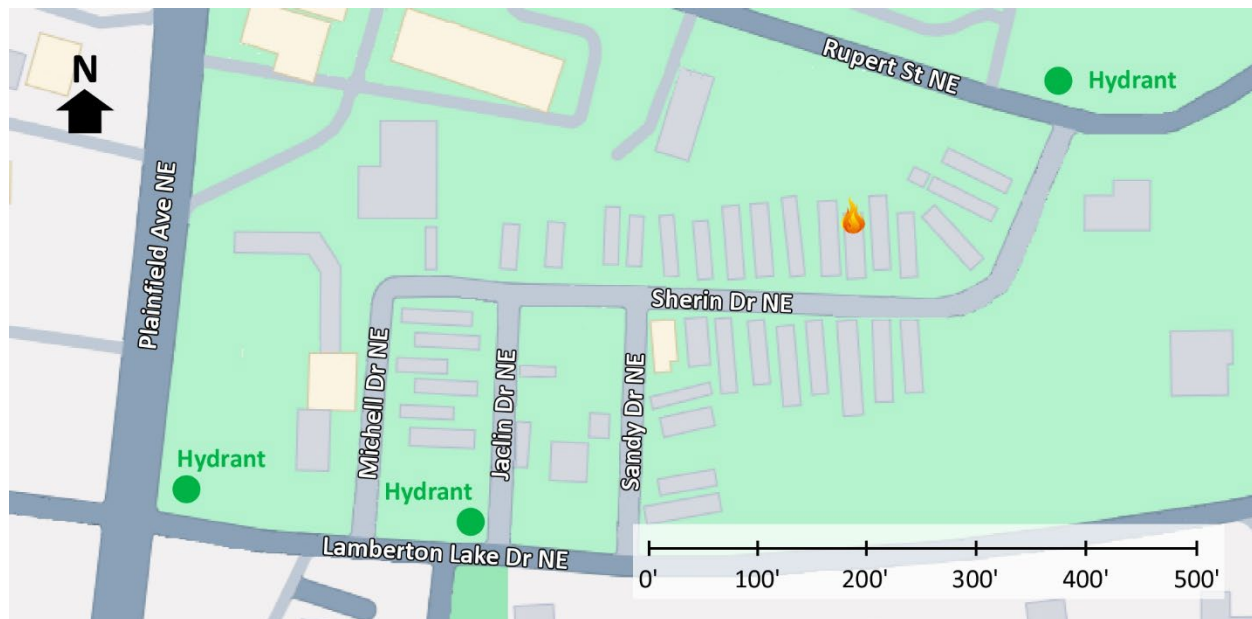

Note: Adapted from Google. (2024a). [Map, 1565 Sherin Drive NE, Grand Rapids, MI].

<https://bit.ly/4dUTvrB>.

Figure 2. Aerial View



Note: Adapted from Google. (2024b). [Aerial view 1565 Sherin Drive NE, Grand Rapids, MI]. <https://bit.ly/3yUnRf5>.

Hydrants are located on Lamberton Lake Drive NE and Rupert Street NE at the entrances to the mobile home community and an additional hydrant is located on Plainfield Avenue NE as illustrated in Figure 1.

Figure 3. Alpha/Bravo Corner



Note: Adapted from Google. (2024c). [3d aerial view 1565 Sherin Drive NE, Grand Rapids, MI]. <https://bit.ly/3T14OGQ>.

Figure 4. Side Delta



Note: Adapted from Google. (2024d). [3d aerial view 1565 Sherin Drive NE, Grand Rapids, MI]. <https://bit.ly/3YSnPPq>.

The temperature is currently 84° F with wind from the south at 5 mph (Weather Underground, 2024). You have been dispatched to 1565 Sherin Drive NE at 13:30 for a residential fire. You are the company officer or AIC of the first arriving engine and have your company's typical staffing.

1. What critical factors would you consider when dispatched and during response and what conversations would you have with your crew while responding?

You hear a command officer, three other engines, and an advanced life support ambulance with typical staffing for your agency go enroute. You will arrive from the east on Sherin Drive NE. The second engine will arrive from the same direction four minutes after you. The command officer will arrive shortly after the second engine. All other units dispatched on the first alarm will arrive after the command officer.

Watch the [incident video](#) (GWW09, 2024) from 00:26 to 00:31 and examine Figure 5 illustrating conditions on arrival.

Figure 5. Conditions on Arrival



Note: Adapted from GWW09. (2024). *Plainfield Township Engine 3 on scene mobile home fire 08/01/24*. <https://bit.ly/4fTVkqD>.

2. State your initial radio report (IRR) exactly as you would transmit it to dispatch.

3. What specific actions would you take (as the company officer) immediately upon arrival and exiting the apparatus and what task orders would you give your crew? State the task orders exactly as you would give them.

A civilian occupant reports that he escaped from the mobile home without injury. Conditions on Sides Charlie and Delta are consistent with those observed on Sides Alpha and Bravo.

4. Would you change the action you are taking or modify the assignments given to your crew? If so, what task orders would you provide?

5. State your update report exactly as you would transmit it to dispatch.

6. Engine 2 arrives and reports that they are Level 1 on a hydrant, on Rupert Street NE. State the tactical assignment you would give them exactly as you would transmit it.

7. Based on the anticipated effectiveness of your tactical operations, state your conditions, actions, and needs (CAN) report that you would provide to the first arriving command officer as part of command transfer to IC #2.

Reflect on your strategic decision-making and responses to questions 1 through 7 before answering the next six questions.

8. What was the problem?

9. What was getting in the way of achieving your tactical priorities?

10. Was there anything in this incident that could have hurt or killed you (right now)?

11. Was it reasonable to believe that the Main Fire Occupancy was occupied?

12. Was there searchable space?

13. If you believed it was reasonable that the building was occupied and there was searchable space, what could you do about it?

Watch the [incident video](#) (GWW09, 2024) from 00:31 to 01:35.

14. Was the initial attack line deployed in an efficient manner? If so, what factors impacted the efficiency of this task? If not, how could the efficiency of this stretch have been improved.

Watch the [incident video](#) (GWW09, 2024) from 01:36 to the end.

15. The first arriving company performed a quick hit from Side Charlie and remained in an exterior position applying water rather than quickly transitioning to the interior. Were the actions of the first arriving company different than your incident action plan? If so, what critical factors influenced your decision-making and tactical assignments?

Keep in mind that tactical operations by the second arriving company were not visible in the video.

Additional Learning: The floor plans typical of single wide mobile homes are considerably different than other types of residential occupancies. Examine the floor plan illustrated in Figure 6 and discuss how arrangement and configuration would impact interior offensive operations including fire control and search with your crew. Note that this floor plan may be different than in the single wide mobile home involved in the incident examined in this 10-Minute Training.

Figure 6. Single Wide Floor Plan

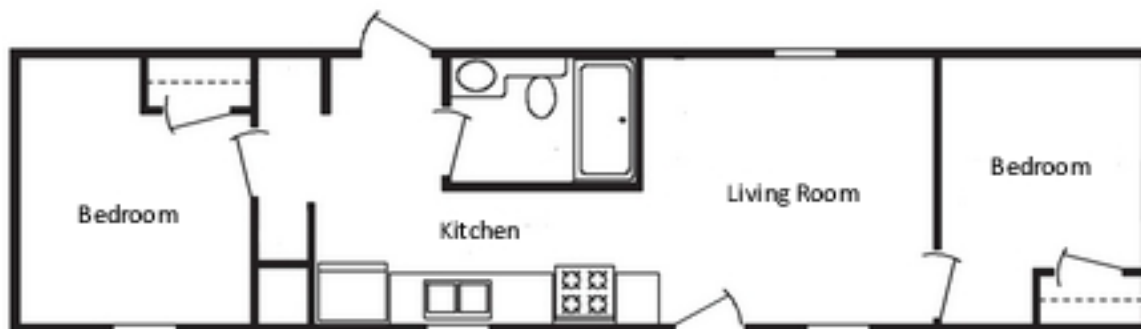

Note: Adapted from Fairmont Homes. (2024). Zenas | 2 Beds · 1 Bath · 525 SqFt. <https://bit.ly/3AFivVx>.

References

Fairmont Homes. (2024). Zenas | 2 Beds · 1 Bath · 525 SqFt. Retrieved August 23, 2024, from <https://bit.ly/3AFivVx>.

Fox 17 News. (2024). *No injuries in NE Grand Rapids mobile home fire*. Retrieved August 23, 2024, from <https://bit.ly/46XOsVc>.

Google. (2024c). [3d aerial view 1565 Sherin Drive NE, Grand Rapids, MI]. Retrieved August 23, 2024, from <https://bit.ly/3T14OGQ>.

Google. (2024d). [3d aerial view 1565 Sherin Drive NE, Grand Rapids, MI]. Retrieved August 23, 2024, from <https://bit.ly/3YSnPPg>.

Google. (2024a). [Map, 1565 Sherin Drive NE, Grand Rapids, MI]. Retrieved August 23, 2024, from <https://bit.ly/4dUTvrB>.

Google. (2024b). [Aerial view 1565 Sherin Drive NE, Grand Rapids, MI]. Retrieved August 23, 2024, from <https://bit.ly/3yUnRf5>.

GWW09. (2024). *Plainfield Township Engine 3 on scene mobile home fire 08/01/24*. Retrieved August 23, 2024, from <https://bit.ly/4fTVkqD>.

Weather Underground (2024). *Grand Rapids, MI weather history* [historical weather August 1, 2024]. Retrieved August 23, 2024, from <https://bit.ly/4dxd35F>.